

ICE AND SWIMMING STADIUM

Stahlhallen und Baustoffe Janneck GmbH
Molbergen, Germany



PROJECT DESCRIPTION

- Location: Cologne, Germany
- Architecture office: Schultitz GmbH
- Dimensions: 10.50 m high, 80 m wide and long
- Specifications: Total weight of 400 tons
- Description: new stadium with three different areas (ice stadium, swimming pool and locker rooms/restaurants area), and an ice rink going around the building as a 1st floor



THE CHALLENGE

- Triangular shape of the building
- Diamond-shaped arrangement of the roof girders
- Different spans of roof girders in the single areas



THE SOLUTION

- Comprehensive modeling tools
- Library of intelligent connections
- Automatic creation of workshop drawings with customized layout

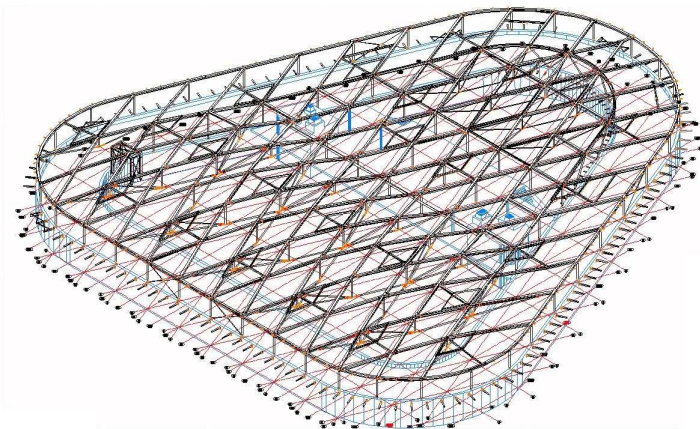

"Without the use of Advance Steel with its many excellent functions, especially the 3D ability, the realization of this project would not have been possible for us."

Mr. Manfred Dröge,
Construction engineer

USERS' BENEFITS

- 3D modeling
- Automatic creation of documents
- Easy to use software with a very good cost/performance ratio

ADVANCE STEEL