

U2 360° TOUR STAGE

STAGECO

Tildonk, Belgium



Project description

- **Location:** worldwide concert tour
- **Structure type:** touring stage for the U2 360° Tour
- **Art design:** Willie Williams (U2 production manager) and the Mark Fisher studios
- **STAGECO R&D project designer:** Koen Peeters
- **Structure weight:** 240 Tons per touring system



The challenge

- Study this complex structure "spaceship-on-four-legs" in 3D
- Get clear drawings for easy erection
- Fabricate the steel structure without any risk of errors



The solution

- Use Advance Steel, a 3D steel modeling and detailing software
- Drawings with 3D view and 3D details for easy understanding at site
- Workshop drawings automatically created by Advance Steel

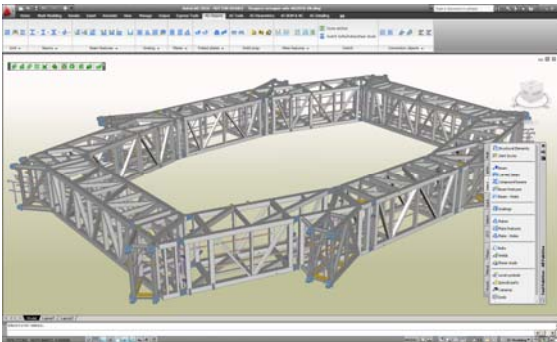

"- The use of Advance Steel and its easy-to-use 3D modeling has significantly contributed to the success of fabricating and delivering the steel structure on time and without errors at site."

Mr. Koen Peeters, STAGECO R&D project designer

Users' benefits

**Advance Steel 3D drawings were much more illustrative than 2D drawings
Necessary information for an accurate fabrication**

ADVANCE STEEL



More projects on www.graitec.com