

COKE OVEN GAS DESULPHURIZATION

HUTNI PROJEKT Frydek-Mistek a.s.
Kosice, Slovakia



PROJECT DESCRIPTION

- Location: Kosice, Slovakia
- Architecture office: Hutni Projekt FM
- Contracting authority: U.S. Steel Kosice, s.r.o
- Dimensions: Coke oven gas desulphurization: 44X22,5X36 m, Regeneration of washing liquids: 7X21X29 m, Modified sulphur production unit: 21X28X12 m
- Specifications: Total tonnage of steel structures : 965 tons
- Description: The subject of the project is designing different steel platforms, constructions under technological devices, pipeline bridges, and canopies for tanks, etc.



THE CHALLENGE

- Handle a huge structure and a run a clash check verification between supporting steel parts and equipments
- The structure contains many platforms with railings, stairs and cage ladders which must be designed in a short time
- Exchange the model with Plant Design software



THE SOLUTION

- The Advance Steel clash checks works on parts imported from different applications
- Advance Steel provides efficient automatic macros to create railings, stairs, etc.
- Many file format exchange options allowing the exchange of the 3D model

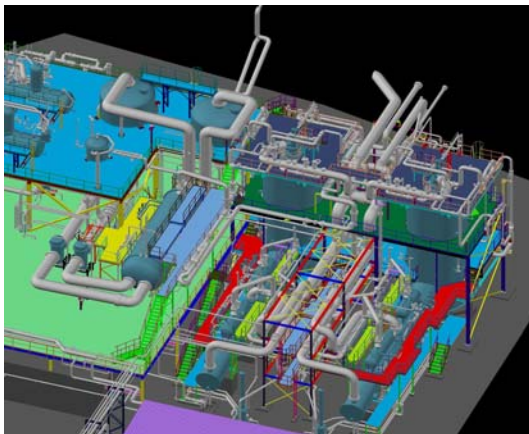

"Using Advance Steel, we were able to model together steel elements with equipments and check the interference between them."

Roman Lisnik,
Designer Engineer

USERS' BENEFITS

- Collisions between steel parts and equipments
 - Visualization in 3D rendered mode
- Efficient creation of stairs and railings

ADVANCE STEEL