

# FIRE ESCAPE

SPRL Lardinois  
Gosselies, Belgium

## PROJECT DESCRIPTION

- Location: Waure, Belgium
- Architecture Office: ASSAR
- Contracting Authority: GSK
- Dimensions: 13m high x 5,4m wide
- Specifications: Multi-level fire escape

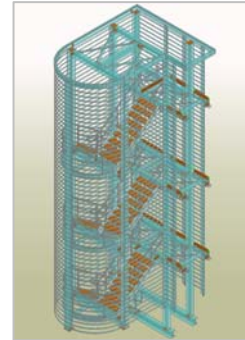

## THE CHALLENGE

- The complexity of the project made it impossible to implement it manually or using AutoCAD
- Move the already mounted fire escape to the building site for quick mounting on site



## THE SOLUTION

- Library already including stairs (steps, balustrades)
- More accurate views with 3D modeling

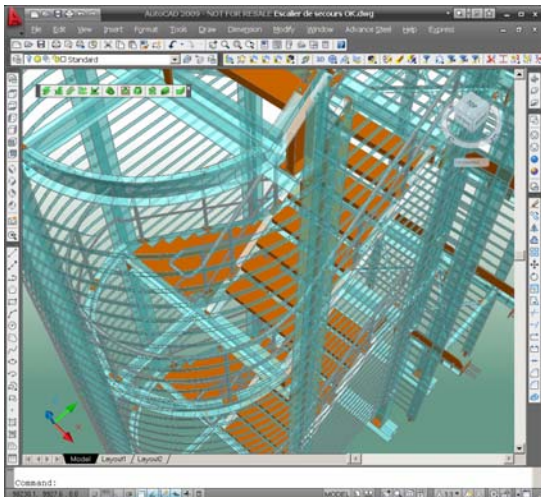

*"Advance Steel is a very good solution for industrial detailing. In addition, the software has a short learning curve for professionals who already use AutoCAD."*

*Mr. Barillet,  
Draftsman*

## USERS' BENEFITS

- Easier and quicker implementation
- Significant time savings with automatic joints and workshop drawings